

Coaxial Circulators/Isolators

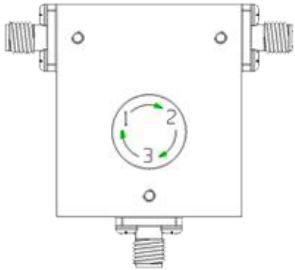

COAXIAL CIRCULATORS / ISOLATORS

ALTERNATE CONNECTOR TYPE AVAILABLE
 AVERAGE POWER: 10 TO 50 W
 PEAK POWER: 3 KW
 OPERATING TEMPERATURE: -30 TO + 70 DEGREES C.
 MATERIAL: ALUMINUM
 RF SHIELDED
 MIL-E-5400 AND MIL-STD-2036
 DIMENSIONS IN INCHES

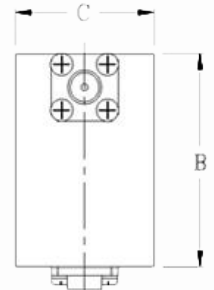
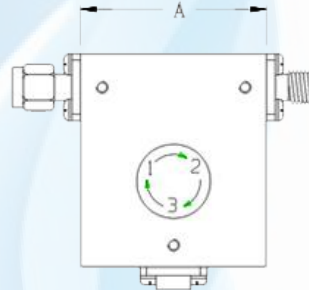

Coaxial Circulators / Isolators

1 year warranty / No minimum order / Price: \$100 & UP

Model No. (CIRC/ISO)	Frequency (GHz)	Insert. Loss (dB Max)	Isolation (dB Min)	VSWR (Max)	Dimensions (Inch/mm max)		
					A	B	C
1801100/1901100	1.000-2.000	0.5	18	1.3	2.80	2.80	1.00
1802100/1902100	1.500-1.900	0.4	20	1.25	1.25	1.25	1.00
1803100/1903100	1.700-2.000	0.4	20	1.22	1.00	1.00	1.00
1804100/1904100	1.700-2.300	0.3	20	1.22	1.70	1.70	1.00
1805100/1905100	1.700-2.700	0.5	18	1.3	1.70	1.70	1.00
1806100/1906100	2.000-3.000	0.4	20	1.25	2.00	2.00	1.00
1807100/1907100	2.000-4.000	0.4	20	1.25	1.70	1.70	1.00
1808100/1908100	2.500-3.500	0.4	20	1.25	1.00	1.00	1.00
1809100/1909100	3.000-6000	0.4	20	1.25	1.00	1.00	1.00
1810100/1910100	3.600-4.200	0.2	26	1.15	1.00	1.00	1.00
1811100/1911100	3.600-7.000	0.5	16	1.4	1.70	1.70	1.00
1812100/1912100	4.000-8.000	0.4	20	1.3	1.00	1.00	1.00
1813100/1914100	4.400-5.000	0.3	23	1.15	1.00	1.20	1.00
1815100/1915100	5.000-6.200	0.4	20	1.25	1.00	1.20	1.00
1816100/1916100	5.900-8.500	0.3	20	1.25	0.75	0.75	1.00
1817100/1917100	6.000-10.000	0.5	17	1.35	0.75	0.75	1.00
1818100/1918100	6.500-18.000	1.2	13	1.6	0.75	0.75	1.00

Model No. (CIRC/ISO)	Frequency (GHz)	Insert. Loss (dB Max)	Isolation (dB Min)	VSWR (Max)	Dimensions (Inch/inm max)		
					A	B	C
1819100/1919100	7.000-9.000	0.4	21	1.20	0.75	0.70	1.00
1820100/1920100	8.000-12.000	0.4	20	1.25	0.9	0.90	0.75
1821100/1921100	9.000-11.000	0.4	23	1.25	0.9	0.90	1.00
1822100/1921100	9.200-12.200	0.4	20	1.25	0.9	0.85	0.75
1823100/1923100	10.000-15.000	0.4	20	1.25	0.75	0.70	0.75
1824100/1924100	12.000-18.000	0.4	20	1.25	0.75	0.80	0.75
1825100/1925100	13.000-16.000	0.4	20	1.25	0.75	0.80	0.75
1826100/1926100	14.000-16.500	0.5	23	1.25	0.75	0.80	0.75
1827100/1927100	18.000-26.500	0.5	20	1.25	0.6	0.70	0.50
1828100/1928100	19.000-22.000	0.5	20	1.25	0.6	0.70	0.50
1829100/1929100	22.000-26.500	0.5	20	1.25	0.6	0.70	0.50

Warranty

Overwave Labs warrants to purchaser that the products and any repaired products will be free from defects in material and workmanship for a period of minimum one year (the warranty period varies up to 3 years, depending on the product category) from the date of shipment to Purchaser. Overwave Labs's obligation under this warranty is limited to replacing or repairing products or repaired products found by Overwave Labs to be defective within the warranty period. All such replacements and repairs shall be performed at facilities designated by Overwave Labs and shall be performed only after the customer has received a Return Material Authorization (RMA) number from us and has returned the product to Overwave Labs, shipping and insurance prepaid by purchaser.

The returned product must be accompanied by the customer's name, address and telephone number, the model and serial number of the Product, a statement of the purchase date and a detailed description of the problem. Products returned by purchaser shall be repaired by manufacturer, shipping prepaid by Overwave Labs.



This warranty shall immediately be null and void if, in Overwave Labs sole judgment, the Product has been subject to unauthorized modification, misuse, abuse, neglect, accident, improper installation or application, alteration or neglect in use, storage, transportation or handling, or if the serial number and/or other product markings have been removed, defaced or altered.

Overwave Labs, may, at its discretion, perform out of warranty repairs at Overwave Labs customary charges or enter into a written agreement extending the terms of this warranty at a price stated in such agreement.

MANUFACTURER MAKES NO OTHER WARRANTIES, EXPRESS OR IMPLIED: There are no implied Warranties including warranty of merchantability or fitness for a particular purpose.

Manufacturer shall not be liable for damages resulting from delays in shipment or inability to ship due to normal production and shipment delays or those resulting from acts of God, fires, floods, wars, sabotage, accidents, labor disputes or shortages, plant shutdown or equipment failure, voluntary or involuntary compliance with any law, order, rule or regulation of governmental agency or authority; or inability to obtain material (including power and fuel), equipment or transportation, or arising from any other contingency, circumstances or event beyond the control of the Manufacturer.